

Drain: SPRINGMILL VILLAGES DRAIN **Drain #:** 268
Improvement/Arm: THE CROSSINGS - SECTION 1A
Operator: JDH **Date:** 5-14-04
Drain Classification: Urban/Rural **Year Installed:** 1994

GIS Drain Input Checklist

- Pull Source Documents for Scanning JDH
- Digitize & Attribute Tile Drains N/A
- Digitize & Attribute Storm Drains JDH
- Digitize & Attribute SSD JDH
- Digitize & Attribute Open Ditch N/A
- Stamp Plans JDH
- Sum drain lengths & Validate JDH
- Enter Improvements into Posse JDH
- Enter Drain Age into Posse JDH
- Sum drain length for Watershed in Posse JDH
- Check Database entries for errors JDH

Gasb 34 Footages for Historical Cost
Drain Length Log

Drain-Improvement: SPRINGMILL VILLAGES DRAIN - THE CROSSINGS - SECTION 1A

Drain Type:	Size:	Length SURVEYERS REPAIR	Length (DB Query)	Length Reconcile	W/Apply=15%	
					Price:	Cost:
SSD	6"	2022'	2022'	∅		
RCP	12"	563'	311'	-252'		
	15"	252'	252'	∅		
	18"	∅	∅	∅		
	24"	689'	609'	-80'		
	27"	37'	37'	∅		

Sum: 3563' 3231' -332'

Final Report: _____

Comments:
SR AND AD DISAGREE ON 12" + 24" REPLENTISH

Springmill Villages Drain – The Crossings - Section 1

Bonds: SO36573 = \$176,200.00

Total bond amount split 2 ways:

The Crossings - Section 1A Arm	3,231'
The Crossings - Section 1B Arm	<u>8,588'</u>
Total Footage	11,819'

The Crossings - Section 1A Arm:
 $3231 / 11819 = 0.27 = 27\%$

The Crossings - Section 1B Arm:
 $8588 / 11819 = 0.73 = 73\%$

$27 + 73 = 100$

Cost Per Improvement:

The Crossings - Section 1A Arm:
 $176,200.00 * 27\% = \$47,574.00$

The Crossings - Section 1B Arm:
 $176,200.00 * 73\% = \$128,626.00$

$\\$47,574.00 + \\$128,626.00 = \\$176,200.00$



SURVEYOR'S OFFICE

Hamilton County

Kenton C. Ward, Surveyor

Suite 146

776-8495

One Hamilton County Square

Noblesville, Indiana 46060-2230

May 17, 1994

TO: Hamilton County Drainage Board

RE: Springmill Village Drain-Section 1-A, The Crossings

Attached is a petition, non-enforcement request, plans, calculations, quantity summary and assessment roll for the Springmill Village Drain-Section 1-A, The Crossings. I have reviewed the submittals and petition and have found each to be in proper form.

I have made a personal inspection of the land described in the petition. Upon doing so, I believe that the drain is practicable; will improve the public health; benefit a public highway and be of public utility; and that the costs, damages and expenses of the proposed drain will probably be less than the benefits accruing to the owners of land likely to be benefitted. The drain will consist of the following:

6" SSD	2022 feet	18" RCP	190 feet
12" RCP	60 feet	24" RCP	689 feet
15" RCP	320 feet	27" RCP	35 feet

The total length of the drain will be 3316 feet.

The subsurface drains (SSD) to be part of the regulated drain are those located under the curbs. Only the main SSD lines which are located within the Right-of-Way are to be maintained as regulated drain. Laterals for individual lots will not be considered part of the regulated drain.

I have reviewed the plans and believe the drain will benefit each lot equally. Therefore, I recommend each lot be assessed equally. I also believe that no damages will result to landowners by the construction of this drain. I recommend a maintenance assessment of \$30.00 per lot, \$5.00 per acre for roadways, with a \$30.00 minimum. With this assessment the total annual assessment

for the drain/this section will be \$ 270 ^{ea}

Parcels assessed for this drain may be assessed for the Overman-Harvey Drain and/or Village Farms Drain at sometime in the future.

I believe this proposed drain meets the requirements for Urban Drain Classification as set out in IC 36-9-27-67 to 69. Therefore, this drain shall be designated as an Urban Drain.

I recommend that upon approval of the above proposed drain that the Board also approve the attached non-enforcement request. This request is for the reduction of the regulated drain easement to those easement widths as shown on the secondary plat for Section 1-A, The Crossings at Springmill Village as recorded in the office of the Hamilton County Recorder.

I recommend the Board set a hearing for this proposed drain for July 1994.

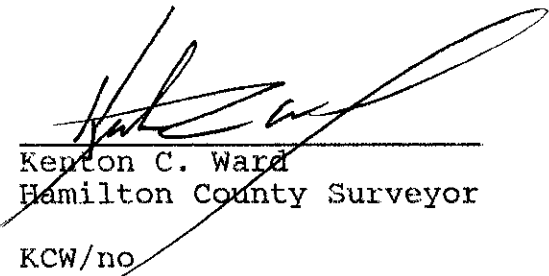

Kenton C. Ward
Hamilton County Surveyor

KCW/no

CERTIFICATE OF COMPLETION AND COMPLIANCE

FILED

TO: HAMILTON COUNTY SURVEYOR

RE: The Crossings Section I
@ Springmill Villages

OFFICE OF HAMILTON COUNTY SURVEYOR

I hereby certify that:

- 1.) I am a Registered Engineer in the State of Indiana,
- 2.) I am familiar with the plans and specifications for the above referenced subdivision,
- 3.) I have personally observed and supervised the completion of the Drainage Facilities for the above referenced subdivision, and
- 4.) To the best of my knowledge, information and belief, the Drainage Facilities within the subdivision has been installed and completed in conformity with all plans and specifications.

Signature: _____

Date: _____

9/1/94

Type or Printed Name: Duane A. Sharrer

Business Address: 3020 North Post Road

Indianapolis, IN 46226

Telephone: 317-898-8282

INDIANA REGISTRATION NUMBER

890258

SEAL



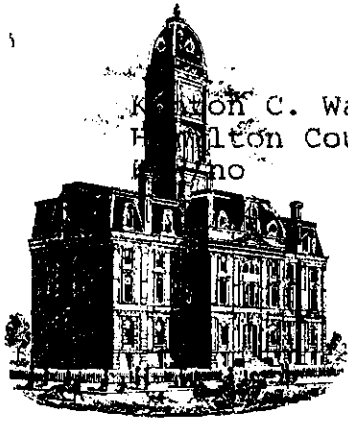

Kenton C. Ward
Hamilton County
Indiana

SURVEYOR'S OFFICE
Hamilton County

Kenton C. Ward, Surveyor

Phone (317) 776-8495

Fax (317) 776-9628

Suite 146

One Hamilton County Square

Noblesville, Indiana 46060-2230

July 23, 1996

TO: Hamilton County Drainage Board

RE: Springmill Villages Drain-The Crossing Section 1A

Attached are As-Builts, Certificate of Completion and Compliance, and other information for Springmill Villages Drain-The Crossing Section 1A. An inspection of the drainage facilities for this section has been made and the facilities were found to be complete and acceptable.

During construction, changes were made to the drain which will alter the plans submitted with my report for this drain dated May 17, 1994. The changes are as followed:

STR 101 to 102	27"	RCP	lengthened from	35'	to	37 feet
STR 102 to 103	24"	RCP	shortened from	73'	to	71 feet
STR 104 to 125	24"	RCP	lengthened from	160'	to	161 feet
STR 125 to 128	24"	RCP	lengthened from	130'	to	131 feet
STR 127 to 126	12"	RCP	shortened from	28'	to	26 feet
STR 126 to 128	12"	RCP	lengthened from	32'	to	33 feet
STR 109 to 106	12"	RCP	shortened from	60'	to	57 feet
STR 108 to 107	12"	RCP	lengthened from	194'	to	195 feet
STR 107 to 106	15"	RCP	shortened from	64'	to	62 feet
STR 105 to 106	15"	RCP	lengthened from	189'	to	190 feet

The corrected totals of pipe are as follows:

27"	RCP	37 feet	15"	RCP	252 feet
24"	RCP	689 feet	12"	RCP	563 feet
18"	RCP	0 feet	6"	SSD	2022 feet

The length of the drain due to the changes described above is now 3,563 feet.

The non-enforcement request was approved by the Board at its meeting on February 27, 1995.

Page #2

The Bond of Letter of Credit from NBD, number 036573, dated May 26, 1994, in the amount of \$176,200.00 has expired.

I recommend the Board approve the drains construction as complete and acceptable.

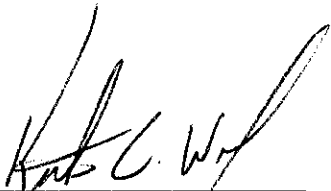

Kenton C. Ward
Hamilton County Surveyor
KCW/no

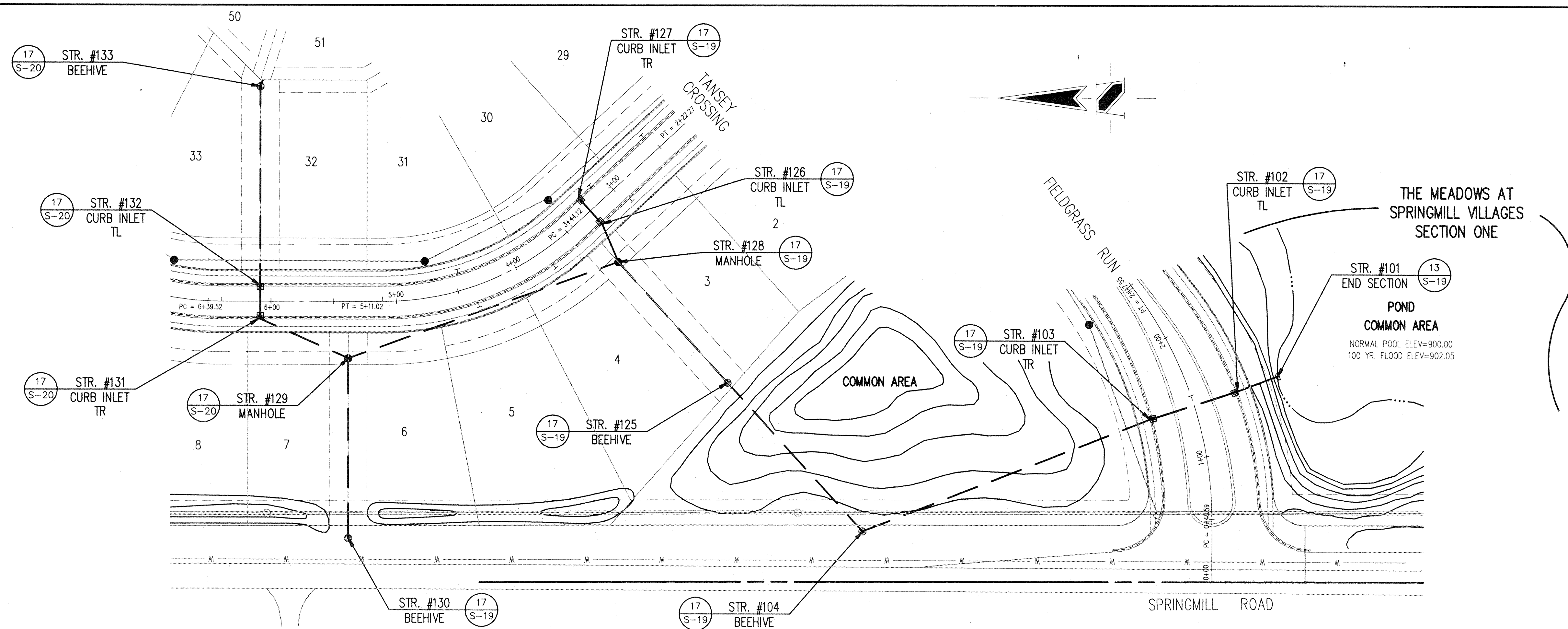

- GENERAL NOTES:
1. ALL CUTS ARE TAKEN FROM THE EXISTING GRADE TO THE PIPE INVERT.
 2. ALL STATIONING IS TAKEN FROM THE NEAREST DOWNSTREAM STRUCTURE.
 3. IT SHALL BE THE CONTRACTORS RESPONSIBILITY TO FIELD VERIFY ALL UTILITY LOCATIONS BEFORE CONSTRUCTION BEGINS.
 4. TEMPORARY TRAFFIC CONTROL DURING CONSTRUCTION TO CONFORM TO APPLICABLE LOCAL AND STATE STANDARDS.
 5. ALL CONSTRUCTION ACTIVITY ON THIS SITE TO BE PERFORMED IN COMPLIANCE WITH APPLICABLE O.S.H.A. STANDARDS FOR WORKER SAFETY.
 6. CONTRACTOR SHALL MINIMIZE DAMAGE TO EXISTING TREES.

HOLEY MOLEY SAYS
"DON'T DIG BLIND"

1-800-382-5544
 CALL TOLL FREE
1-800-428-5200
 FOR CALLS OUTSIDE OF INDIANA

BENCH MARK
 U.S.C.&G. # 93 RWP 1951 BRASS DISK
 IN CONCRETE POST, S.W. CORNER OF
 146th STREET AND DITCH ROAD.
 ELEV.= 903.373

STORM SEWER PLAN

SCALE: 1"=50'

STORM SEWER RECORD DRAWING

CERTIFICATION FOR "RECORD DRAWING"

CERTIFIED BY: *Richard J. Ryback*

SCHNEIDER ENGINEERING CORPORATION
 3020 NORTH POST ROAD
 INDIANAPOLIS, INDIANA 46228-6518
 P.O. BOX 28088 (317) 888-8282

NOTE: Record drawing certification only for top of coating, invert elevations and lengths of pipe. Slope percentage represents a calculated figure and is for general information only.

DATE: 9-6-94

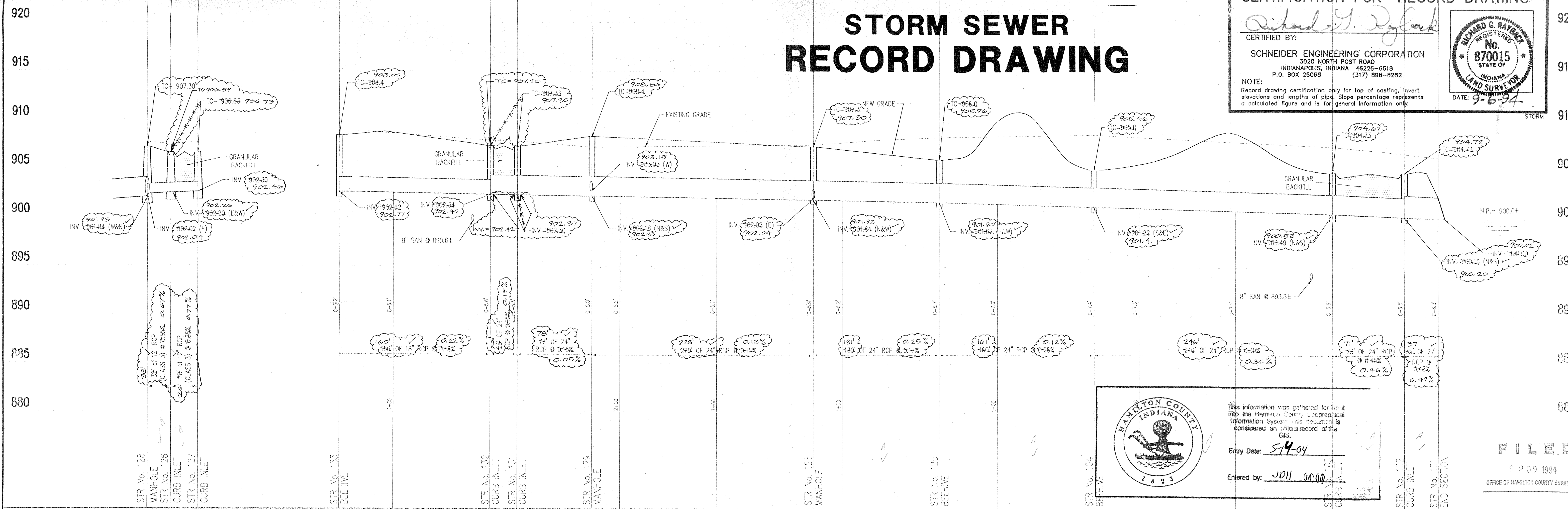

This information was certified for input into the Hamilton County Geographical Information System. The certification is considered an official record of the GIS.

Entry Date: 5-14-04
 Entered by: JDIH (M)

FILED
 SEP 09 1994
 OFFICE OF HAMILTON COUNTY SURVEYOR

STORM SEWER PROFILE

SCALE: HORZ.: 1"=50'
 VERT.: 1"=5'

REVISIONS	DATE	CHECK NO.	BY	DATE	CHECK
1	2/17/94	1	DM	3/2/94	REVISION FOR BRACING CHECK

DRAWN BY: *Richard J. Ryback* 2/19/94

PROJECT: THE CROSSINGS SECTION ONE
 PREPARED FOR: BREWICK DEVELOPMENT CO. INC.
 TITLE: STORM SEWER PLAN & PROFILE

SHEET 5-12 OF 20

HOLEY MOLEY SAYS
"DON'T DIG BLIND"



1-800-382-5544
 CALL TOLL FREE
1-800-428-5200
 FOR CALLS OUTSIDE OF INDIANA

- GENERAL NOTES:
1. ALL CUTS ARE TAKEN FROM THE EXISTING GRADE TO THE PIPE INVERT.
 2. ALL STATIONING IS TAKEN FROM THE NEAREST DOWNSTREAM STRUCTURE.
 3. IT SHALL BE THE CONTRACTOR'S RESPONSIBILITY TO FIELD VERIFY ALL UTILITY LOCATIONS BEFORE CONSTRUCTION BEGINS.
 4. TEMPORARY TRAFFIC CONTROL DURING CONSTRUCTION TO CONFORM TO APPLICABLE LOCAL AND STATE STANDARDS.
 5. ALL CONSTRUCTION ACTIVITY ON THIS SITE TO BE PERFORMED IN COMPLIANCE WITH APPLICABLE O.S.H.A. STANDARDS FOR WORKER SAFETY.
 6. CONTRACTOR SHALL MINIMIZE DAMAGE TO EXISTING TREES.

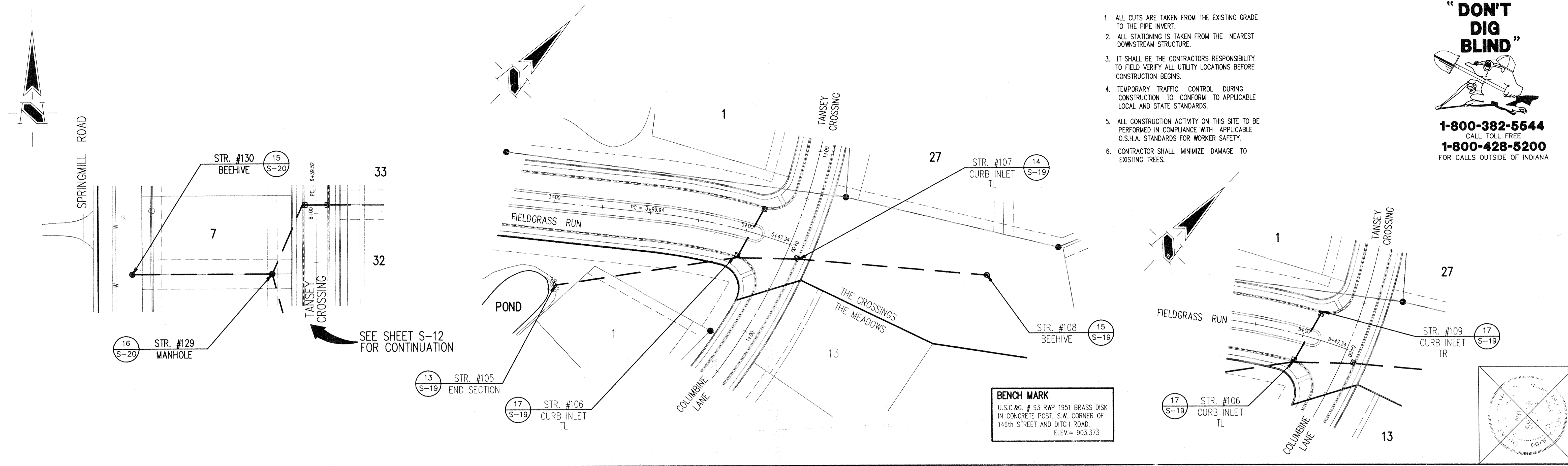

STORM SEWER PLAN

SCALE: 1"=50'

CERTIFICATION FOR "RECORD DRAWING"

CERTIFIED BY: *Richard G. Raybeck*

RICHARD G. RAYBECK
 REGISTERED
 No. 870015
 STATE OF INDIANA
 LAND SURVEYOR

DATE: 9-6-94

SCHNEIDER ENGINEERING CORPORATION
 3020 NORTH POST ROAD
 INDIANAPOLIS, INDIANA 46226-6518
 P.O. BOX 28068 (317) 898-8282

NOTE: Record drawing certification only for top of casting, invert elevations and lengths of pipe. Slope percentage represents a calculated figure and is for general information only.

STORM SEWER RECORD DRAWING

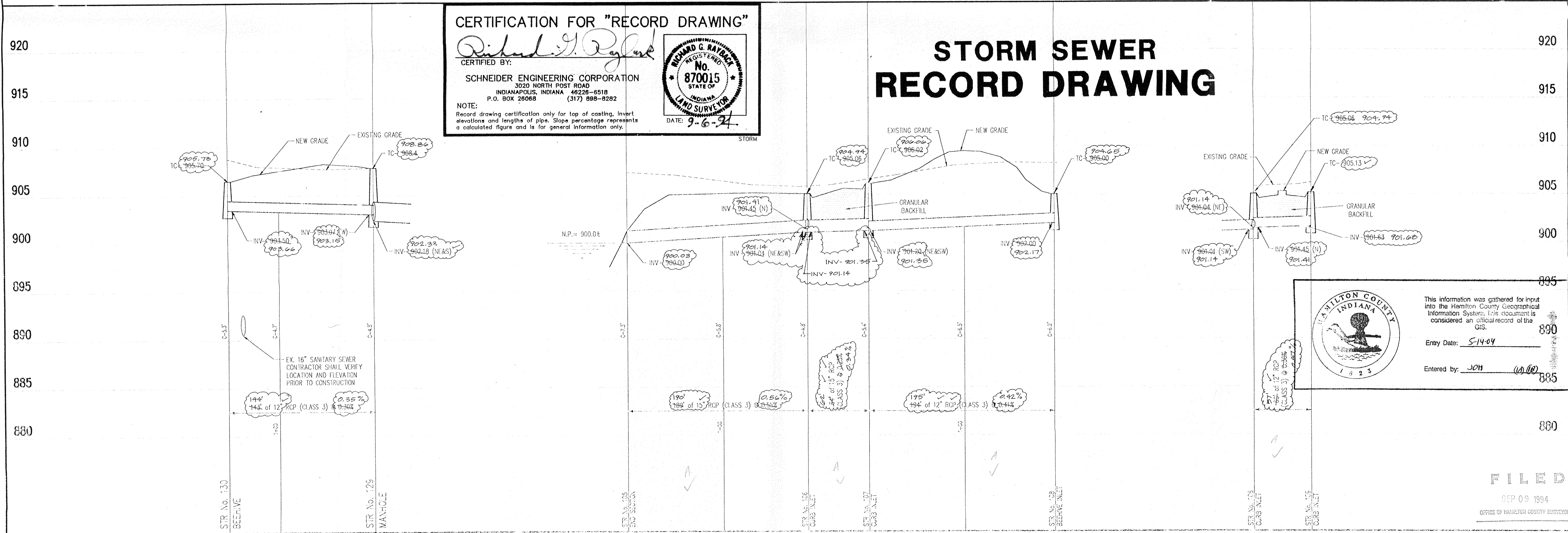

HAMILTON COUNTY INDIANA

This information was gathered for input into the Hamilton County Geographical Information System. This document is considered an official record of the GIS.

Entry Date: 5-14-04

Entered by: JPH (1) (18)

REVISIONS

NO.	DATE	CHECKED BY	DATE	CHECKED BY
1	2/2/94	CSB	3/9/94	CSB

DRAWN BY: CSB

CHECKED BY: CSB

DATE: 2/2/94

DATE: 3/9/94

REVISIONS TO GRADES AT STR. NO. 130 & 109

SCHNEIDER ENGINEERING CORPORATION

Professional Engineers • Land Planners
 Land Surveyors • Geologists

3020 NORTH POST ROAD
 INDIANAPOLIS, INDIANA 46226-6518
 Telephone: (317) 898-8282
 Fax: (317) 898-8010

PROJECT: THE CROSSINGS SECTION ONE

JOB NO. 885-21

PREPARED FOR: BREWICK DEVELOPMENT CO., INC.

TITLE: STORM SEWER PLAN & PROFILE

SCALE: SHOWN

FILED

SEP 09 1994

OFFICE OF HAMILTON COUNTY SURVEYOR

STORM SEWER PROFILE

SCALE: HORZ.: 1"=50'
 VERT.: 1"=5'

This copy printed from the Digital Archive of the Hamilton County Surveyor's Office, One Hamilton Co. Square, Ste. 188, Noblesville, IN 46060

GENERAL NOTES:

1. ALL CUTS ARE TAKEN FROM THE EXISTING GRADE TO THE PIPE INVERT.
2. ALL STATIONING IS TAKEN FROM THE NEAREST DOWNSTREAM STRUCTURE.
3. IT SHALL BE THE CONTRACTORS RESPONSIBILITY TO FIELD VERIFY ALL UTILITY LOCATIONS BEFORE CONSTRUCTION BEGINS.
4. TEMPORARY TRAFFIC CONTROL DURING CONSTRUCTION TO CONFORM TO APPLICABLE LOCAL AND STATE STANDARDS.
5. ALL CONSTRUCTION ACTIVITY ON THIS SITE TO BE PERFORMED IN COMPLIANCE WITH APPLICABLE O.S.H.A. STANDARDS FOR WORKER SAFETY.
6. CONTRACTOR SHALL MINIMIZE DAMAGE TO EXISTING TREES.

HOLEY MOLEY SAYS
"DON'T DIG BLIND"

1-800-382-5544
 CALL TOLL FREE
1-800-428-5200
 FOR CALLS OUTSIDE OF INDIANA

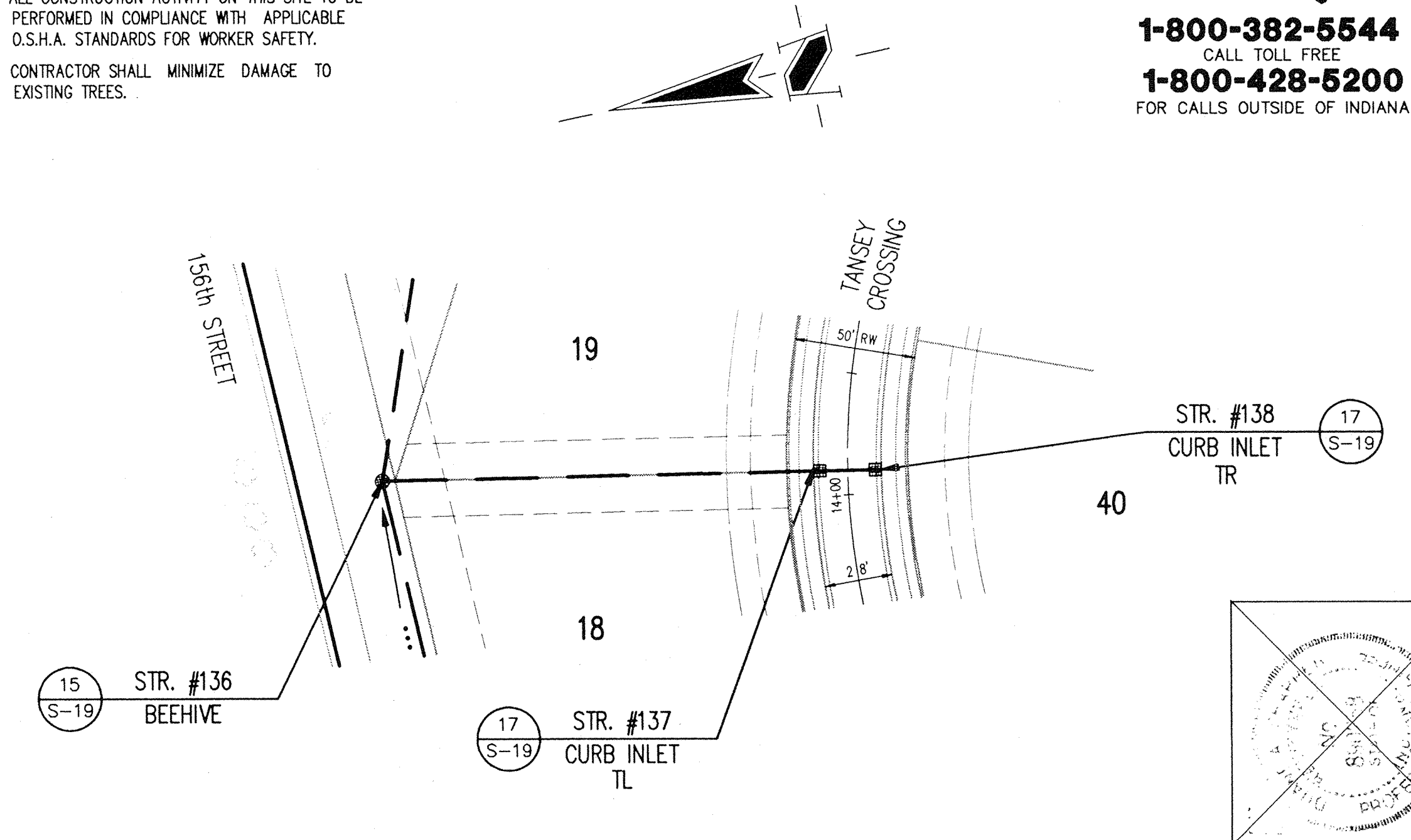
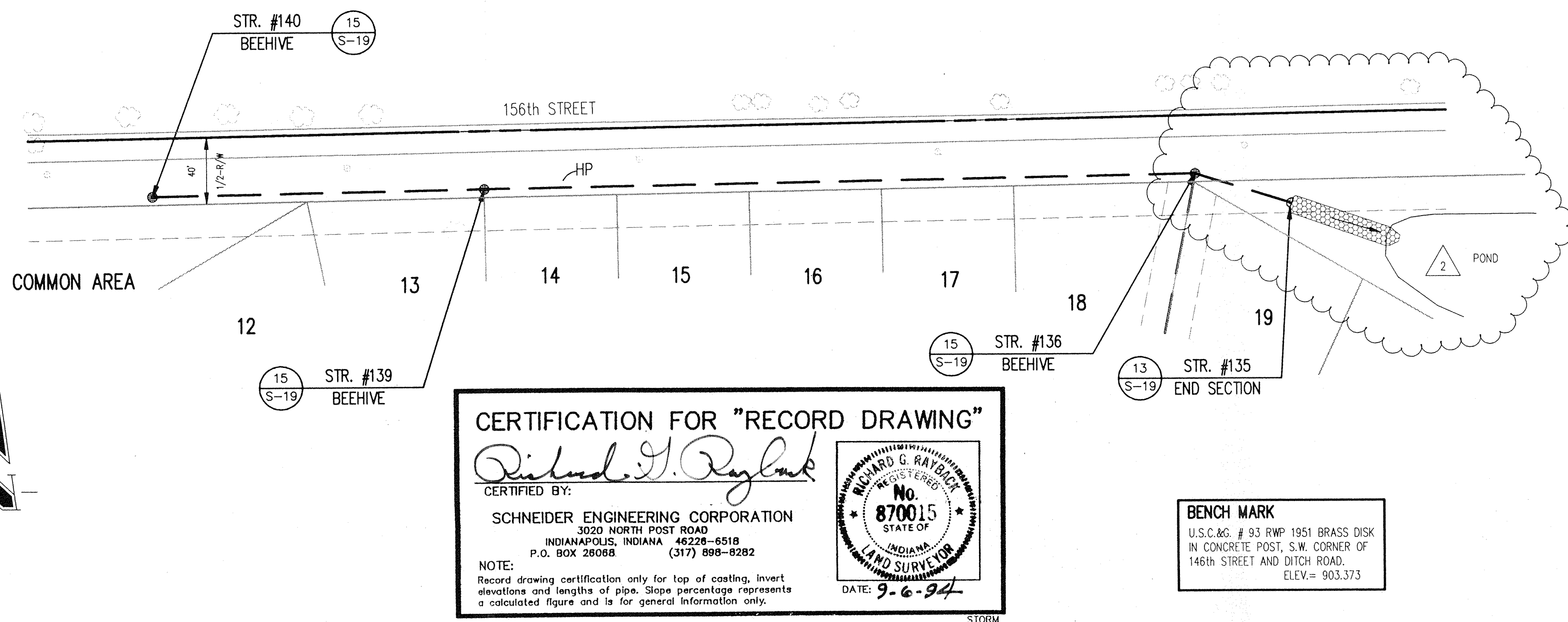

CERTIFICATION FOR "RECORD DRAWING"
 CERTIFIED BY:
Richard G. Raybuck
 SCHNEIDER ENGINEERING CORPORATION
 3020 NORTH POST ROAD
 INDIANAPOLIS, INDIANA 46226-6518
 P.O. BOX 28068 (317) 898-8282
 NOTE: Record drawing certification only for top of casting, invert elevations and lengths of pipe. Slope percentage represents a calculated figure and is for general information only.
 DATE: 9-6-94

BENCH MARK
 U.S.C.&G. # 93 RWP 1951 BRASS DISK
 IN CONCRETE POST, S.W. CORNER OF
 146th STREET AND DITCH ROAD.
 ELEV.= 903.373

STORM SEWER PLAN

SCALE: 1"=50'

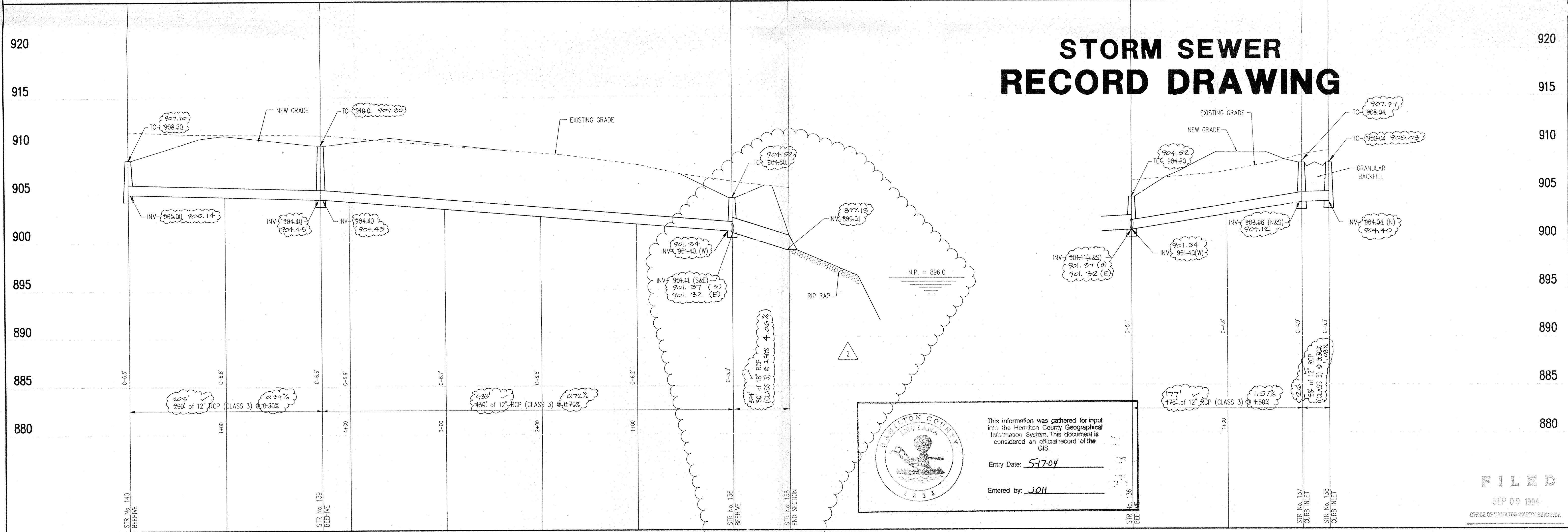

STORM SEWER RECORD DRAWING

This information was gathered for input into the Hamilton County Geographical Information System. This document is considered an official record of the GIS.
 Entry Date: 5-17-04
 Entered by: JQH

STORM SEWER PROFILE

SCALE: HORIZ.: 1"=50'
 VERT.: 1"=5'

REVISIONS

NO.	DATE	CHECKED BY	DATE	CHECKED BY
1	3/9/94	CSB	3/9/94	CSB
2	4/29/94	CSB	4/29/94	CSB

PROJECT: THE CROSSINGS SECTION ONE
 PREPARED FOR: BRENNICK DEVELOPMENT CO., INC.
 TITLE: STORM SEWER PLAN & PROFILE

FILED
 SEP 09 1994
 OFFICE OF HAMILTON COUNTY SURVEYOR

SHEET 14 OF 20

HOLEY MOLEY SAYS
"DON'T DIG BLIND"

1-800-382-5544
 CALL TOLL FREE
1-800-428-5200
 FOR CALLS OUTSIDE OF INDIANA

- GENERAL NOTES:
1. ALL CUTS ARE TAKEN FROM THE EXISTING GRADE TO THE PIPE INVERT.
 2. ALL STATIONING IS TAKEN FROM THE NEAREST DOWNSTREAM STRUCTURE.
 3. IT SHALL BE THE CONTRACTOR'S RESPONSIBILITY TO FIELD VERIFY ALL UTILITY LOCATIONS BEFORE CONSTRUCTION BEGINS.
 4. TEMPORARY TRAFFIC CONTROL DURING CONSTRUCTION TO CONFORM TO APPLICABLE LOCAL AND STATE STANDARDS.
 5. ALL CONSTRUCTION ACTIVITY ON THIS SITE TO BE PERFORMED IN COMPLIANCE WITH APPLICABLE O.S.H.A. STANDARDS FOR WORKER SAFETY.
 6. CONTRACTOR SHALL MINIMIZE DAMAGE TO EXISTING TREES.

NO.	DATE	BY	CHECK
1	1/27/94	CS	CS
2	4/29/94	CS	CS

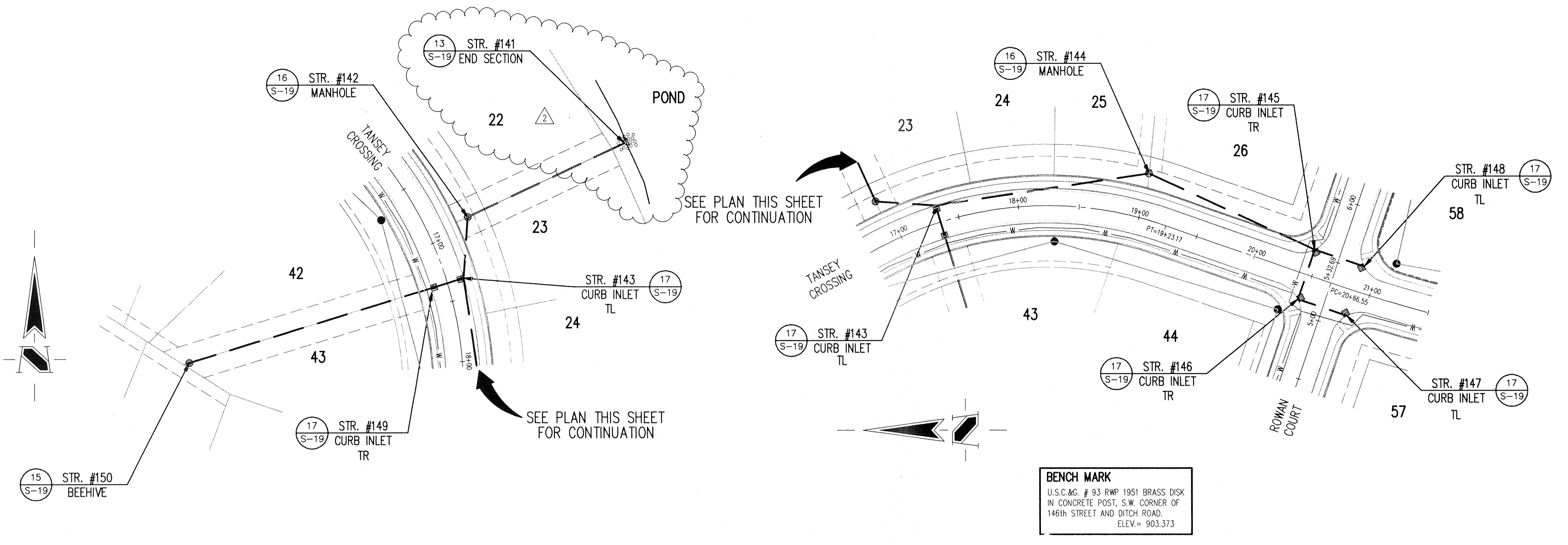

BENCH MARK
 U.S.C. & G. # 93 RWP 1951 BRASS DISK
 IN CONCRETE POST, S.W. CORNER OF
 146th STREET AND DITCH ROAD.
 ELEV. = 903.373

STORM SEWER PLAN

SCALE: 1"=50'

CERTIFICATION FOR "RECORD DRAWING"
 CERTIFIED BY: *Richard J. Payback*
SCHNEIDER ENGINEERING CORPORATION
 3020 NORTH POST ROAD
 INDIANAPOLIS, INDIANA 46226-6518
 P.O. BOX 26068 (317) 898-8282

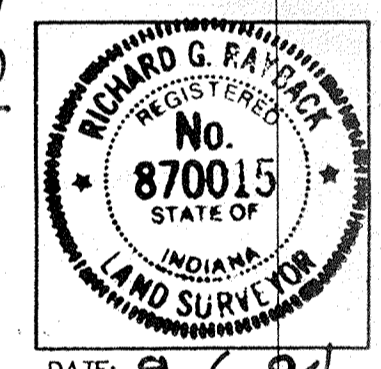

This information was gathered for input into the Hamilton County Geographical Information System. This document is considered an official record of the GIS.
 Entry Date: 5/7/04
 Entered by: JDM



STORM SEWER RECORD DRAWING

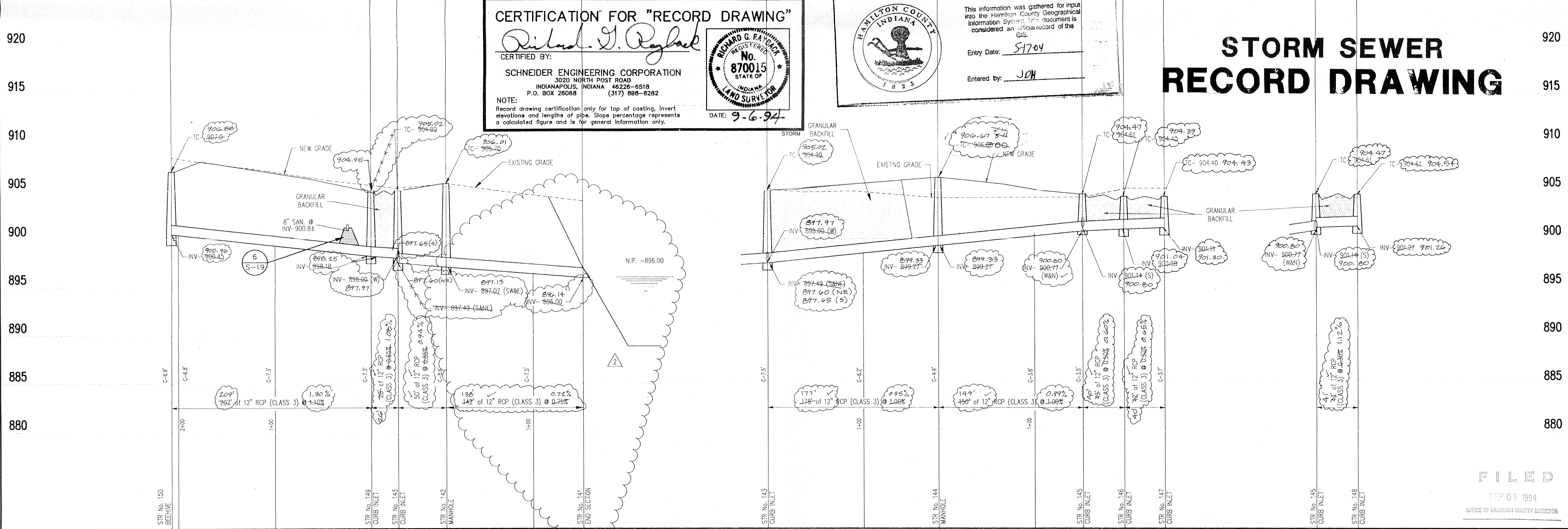

STORM SEWER PROFILE

SCALE: HORIZ.: 1"=50'
 VERT.: 1"=5'

SCHNEIDER ENGINEERING CORPORATION
 Professional Engineers
 Land Planners
 Geologists
 Land Surveyors
 3020 NORTH POST ROAD
 6848 EAST U.S. 36 SUITE 500
 DANVILLE, INDIANA 46121-5000
 INDIANAPOLIS, INDIANA 46226-6518
 Telephone (317) 898-8282
 Fax (317) 699-8010

PROJECT: THE CROSSINGS SECTION ONE 895-21
 PREPARED FOR: BRENNICK DEVELOPMENT CO. INC.
 TITLE: STORM SEWER PLAN & PROFILE
 SCALE: SHOWN
 SHEET: S-15 OF 20

FILED
 SEP 09 1994
 OFFICE OF HAMILTON COUNTY SURVEYOR

This copy printed from the Digital Archive of the Hamilton County Surveyor's Office; One Hamilton Co. Square, Ste. 188, Noblesville, In 46060

HOLEY MOLEY SAYS

"DONT DIG BLIND"

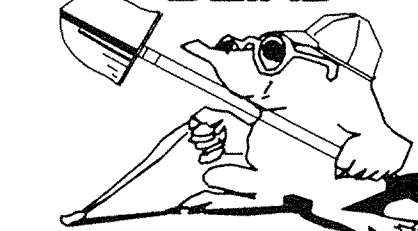

1-800-382-5544
CALL TOLL FREE
1-800-428-5200
FOR CALLS OUTSIDE OF INDIANA

GENERAL NOTES:

1. ALL CUTS ARE TAKEN FROM THE EXISTING GRADE TO THE PIPE INVERT.
2. ALL STATIONING IS TAKEN FROM THE NEAREST DOWNSTREAM STRUCTURE.
3. IT SHALL BE THE CONTRACTORS RESPONSIBILITY TO FIELD VERIFY ALL UTILITY LOCATIONS BEFORE CONSTRUCTION BEGINS.
4. TEMPORARY TRAFFIC CONTROL DURING CONSTRUCTION TO CONFORM TO APPLICABLE LOCAL AND STATE STANDARDS.
5. ALL CONSTRUCTION ACTIVITY ON THIS SITE TO BE PERFORMED IN COMPLIANCE WITH APPLICABLE O.S.H.A. STANDARDS FOR WORKER SAFETY.
6. CONTRACTOR SHALL MINIMIZE DAMAGE TO EXISTING TREES.

DATE	CHECK	NO.	BY	DATE	CHECK
17/94	SSD	1	SSD	17/94	SSD

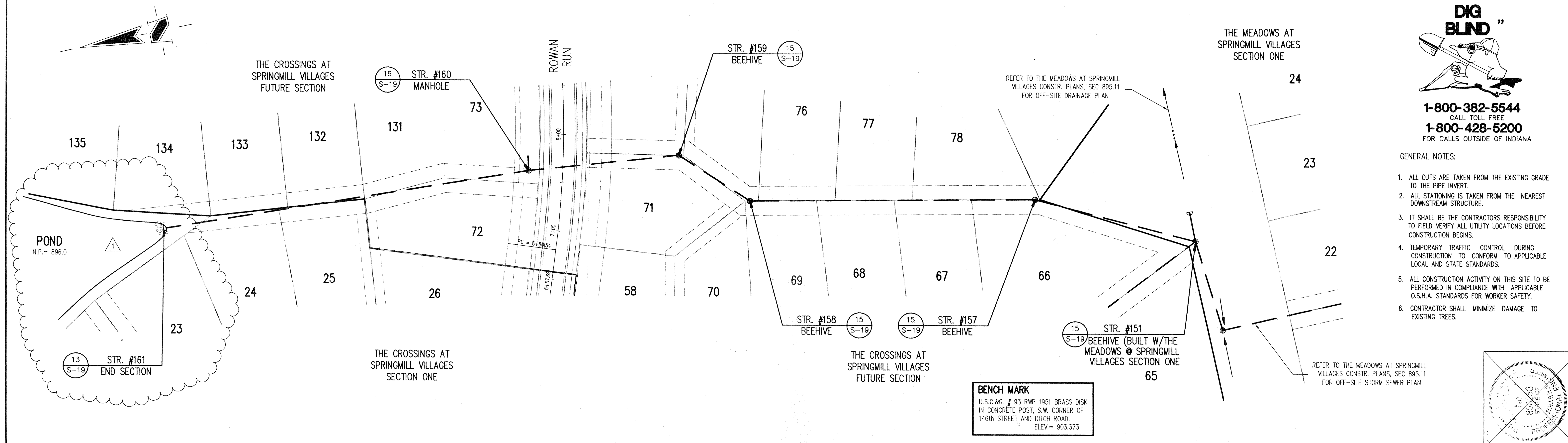

STORM SEWER PLAN

SCALE: 1"=50'

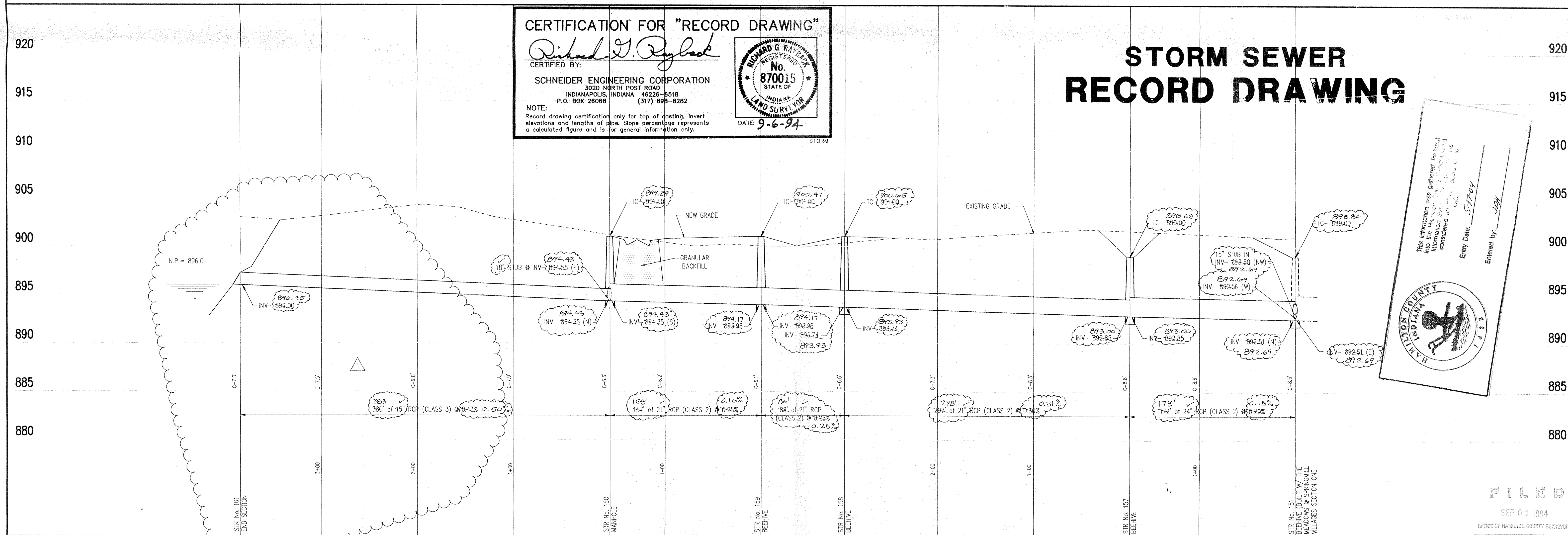

STORM SEWER PROFILE

SCALE: HORIZ.: 1"=50'
VERT.: 1"=5'

SCHNEIDER ENGINEERING CORPORATION
 • Land Planners
 • Professional Engineers
 • Land Surveyors
 • Geologists

3020 NORTH POST ROAD
 INDIANAPOLIS, INDIANA 46226-6518
 Telephone: (317) 898-8282
 Fax: (317) 897-9010

PROJECT: THE CROSSINGS SECTION ONE
 PREPARED FOR: BRENNICK DEVELOPMENT CO., INC.
 TITLE: OFFSITE STORM SEWER PLAN & PROFILE

JOB NO. 895.21
 SCALE: 1"=50'

FILED
 SEP 09 1994
 OFFICE OF HAMILTON COUNTY SURVEYOR

SHEET S-16 OF 20